

# Operation manual for acrylic bending machine ABM(Three heating module)

## Notices before starting

1. Before turning on the machine, please check whether the equipment's parts are normal, whether the switch is in the off state.
2. Check whether the pump is well connected with the equipment, whether the pump is working properly, whether the water tank can meet the requirements of the equipment.
3. Make sure the power supply circuit voltage and power can meet the requirements of equipment work.
4. Make sure the air switch is properly connected to the power supply circuit.
5. Turn on the power switch one by one to make the equipment work normally according to the instructions.
6. As this equipment is a high-power electrical equipment, please pay attention to the safety of power consumption when operating.

## Circuit diagram

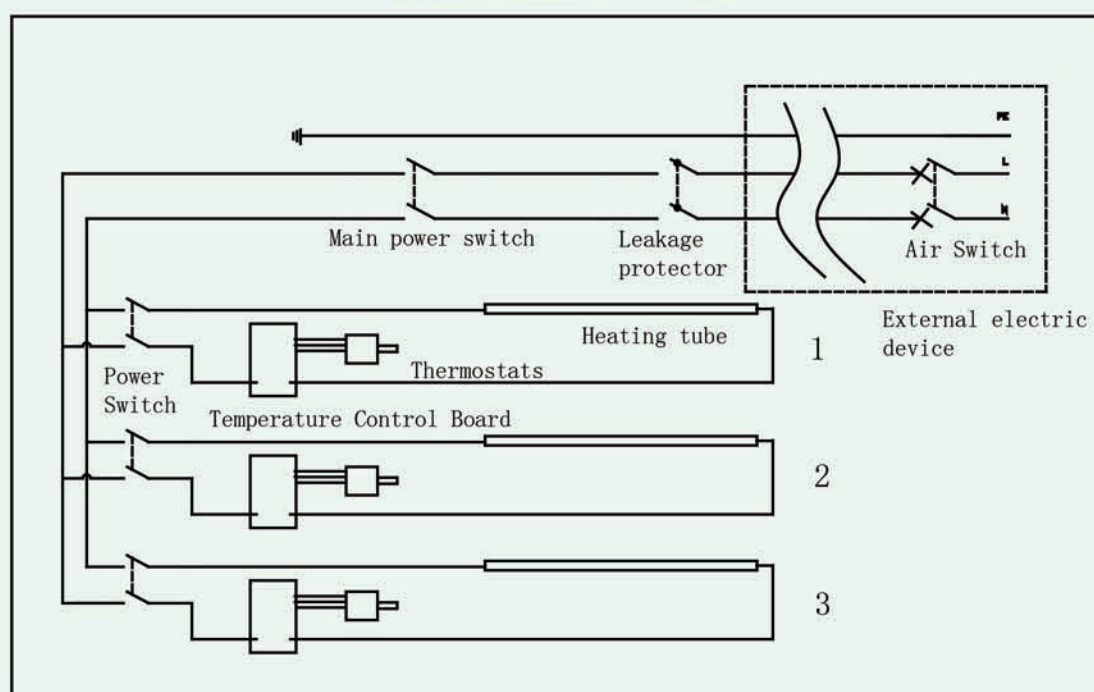

## Spare parts list

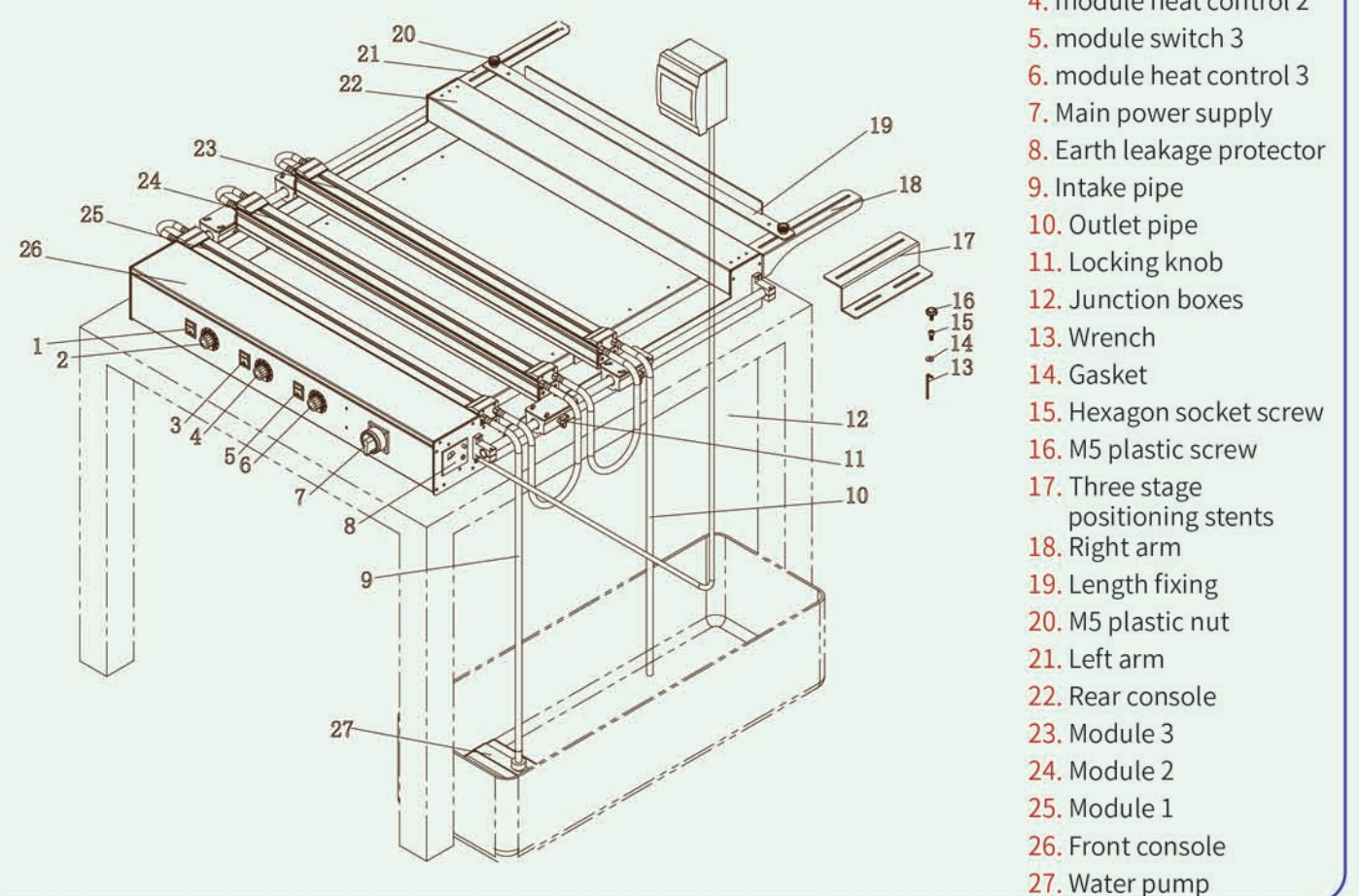

## Startup steps

Step 3

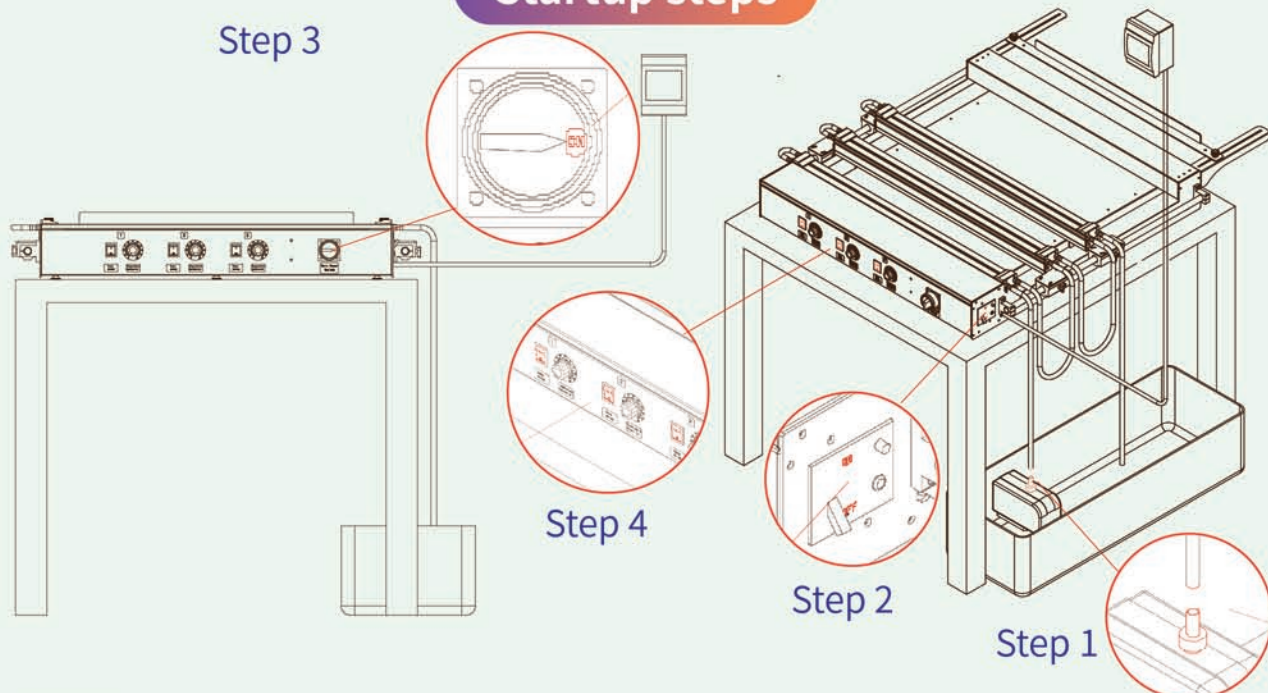

- Step1:** Connect the power lines according to the circuit diagram, prepare the water tank, and fill with not less than 50L of water. Connect the water inlet pipe with the water pump and place it in the water.
- Step2:** Turn the earth leakage protection on (this step is only available for the first time and will be repeated for subsequent trips).
- Step3:** Turn the main power switch to ON.
- Step4:** Turn the switch of the three modules to "ON", and turn the temperature control knob to the maximum to light up the heating tube, then turn to the minimum to see if the brightness of the heating tube changes at the same time, make sure the machine is working properly. Adjust the position of the module according to the number of bending channels and bending position of the product, turn the temperature control knob to the proper temperature, start bending work.
- Note: After the bending work is finished, please turn off the module switch first and then turn off the main power switch.

## Two-stage heating mode

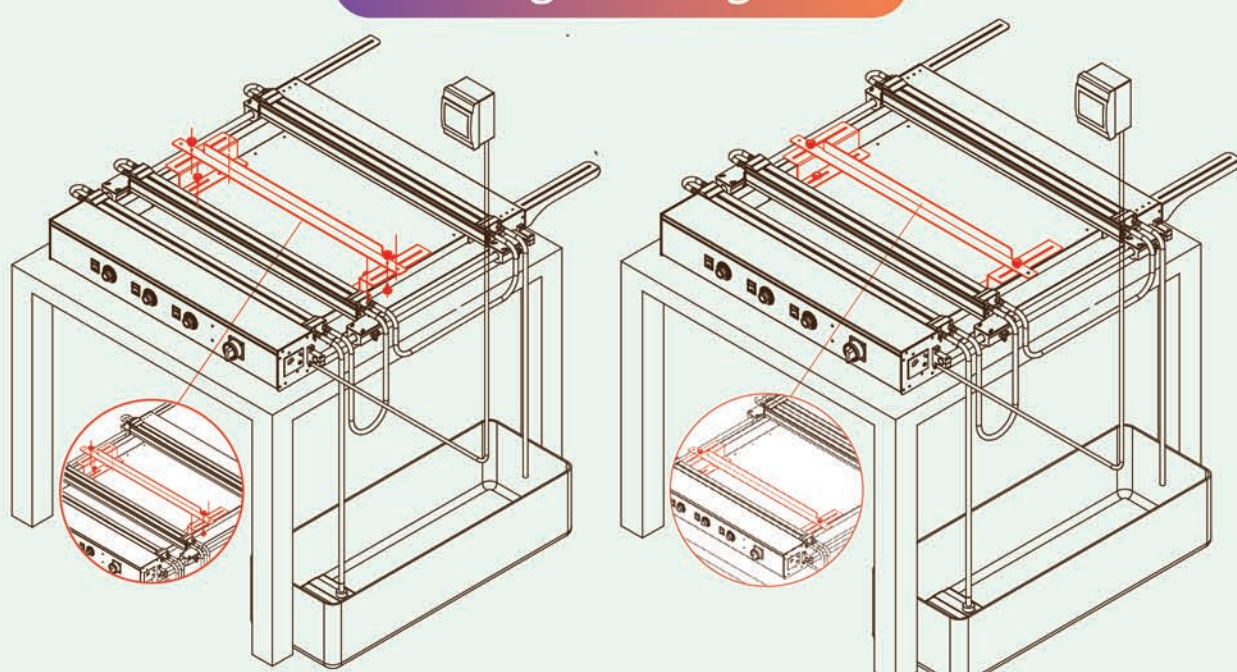

- 2.1.1:** Move the No. 3 module to the operating table close to the rear console, fix the positioning bracket on the mounting hole in the fuselage, and install the length positioning element on the positioning bracket.
- 2.1.2:** Adjust the position of the No. 2 module and the length positioning part according to the need of product bending, and fix the locking knob on both sides of the module, the M5 plastic screw and the M5 plastic nut.

## Single stage heating mode

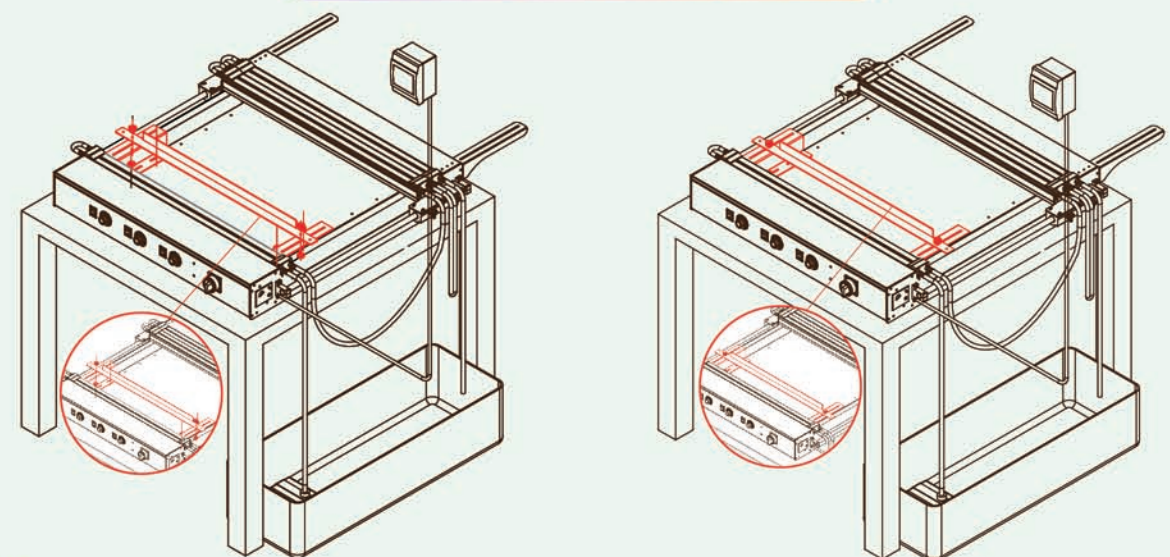

- 1.1.1:** Move No. 2 module and No. 3 module to the operating table close to the rear console, fix the positioning bracket on the front mounting hole of the fuselage, and install the length positioning element on the positioning bracket.
- 1.1.2:** Adjust the position of the length localizer according to the need of product bending, tighten the M 5 plastic screw and the M 5 plastic nut fixed length localizer.

## Three-stage heating mode

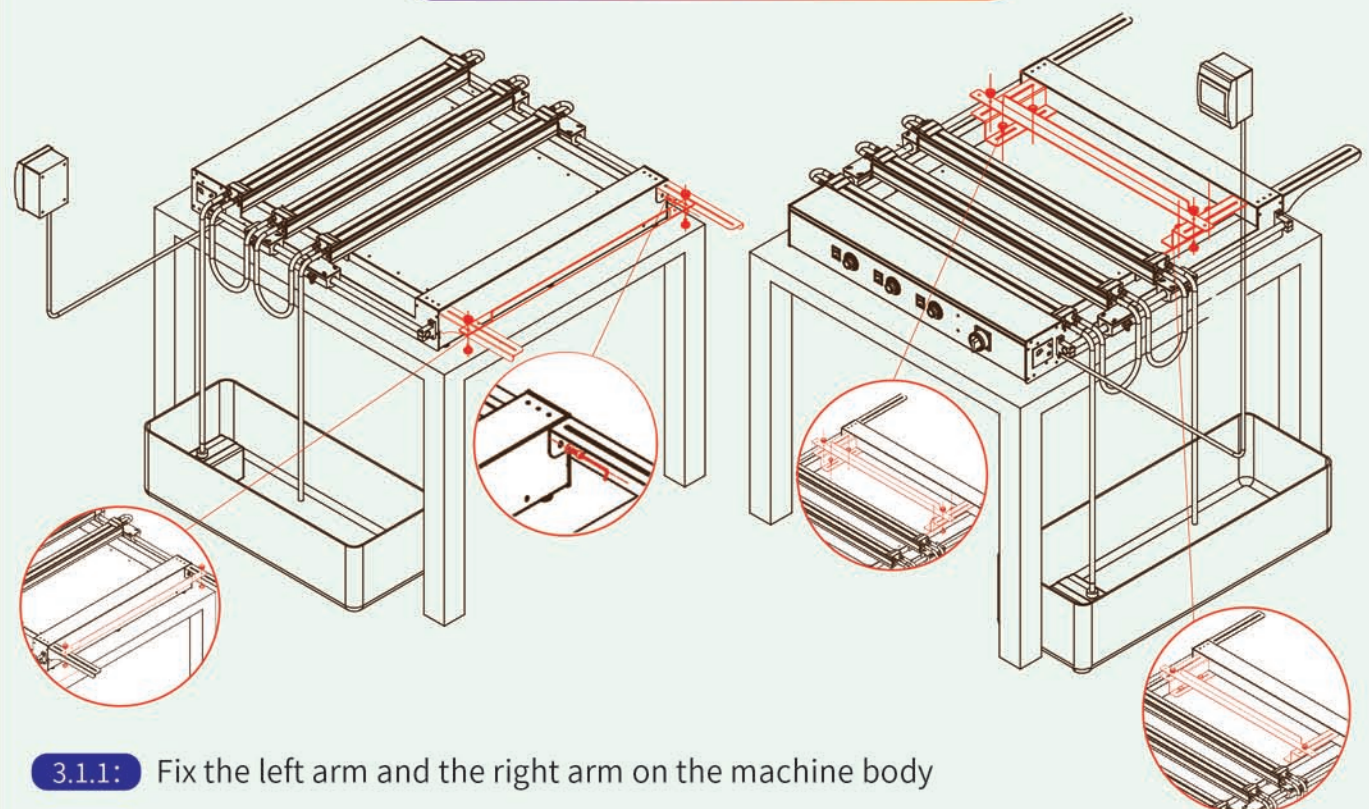

- 3.1.1:** Fix the left arm and the right arm on the machine body
- 3.1.2:** Install the length fixing parts on the left and right arm, adjust the position of module 2 and module 3 and the length fixing parts according to the need of product bending, and fix the locking knob, M5 plastic screw and M5 plastic nut.
- 3.2.1:** Fix the positioning bracket on the mounting hole behind the machine body, fix the length positioning part on the positioning bracket.
- 3.2.2:** Adjust the position of module 2 and module 3 and the length positioning parts according to the need of product bending, and fix the locking knob, M5 plastic screw and M5 plastic nut on both sides of the module.