

Acrylic Bending Machine Operation Manual

1. Parameter

Model: ABM700/1300 Applicable thickness: 1-10mm Width: ≤650mm/≤1250mm N.W: 18/28KG
 Theory: Thermal Forming Voltage: AC220V Outline size: 1000×300×130mm/1650×300×130mm
 Specification: 700/1300MM Temperature range: 0~600°C Power: 1000/1500W Pump power: 40W
 Application materials: plastic plate, acrylic, plexiglass, PVC, PC, ABS, PP etc.

2. Components

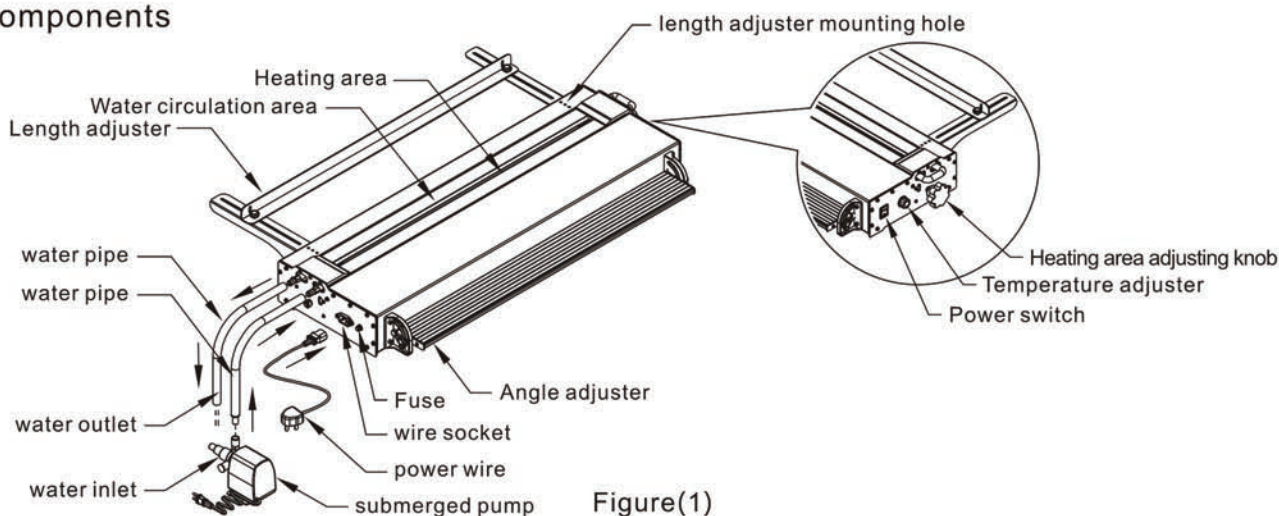

3. Installation

3.1 Machine installation

- (1) Open the package and check all the accessories:
- (2) Put the main machine on a stable table.
- (3) Insert the plug.
- (4) Insert two water pipes, one end of pipe with copper insert stick into the water pump. The other head of both pipe stick into the copper joints on the main machine. (Figure1)

Acrylic bending machine: 1unit	Power wire:1pc	Water pipe:2pcs	Submerged pump:1pc
Angle adjuster:1unit(optional)	Length adjuster:1unit(optional)	Spare heating tube:1pc	

3.2 Installation of angle adjuster and length adjuster (optional)

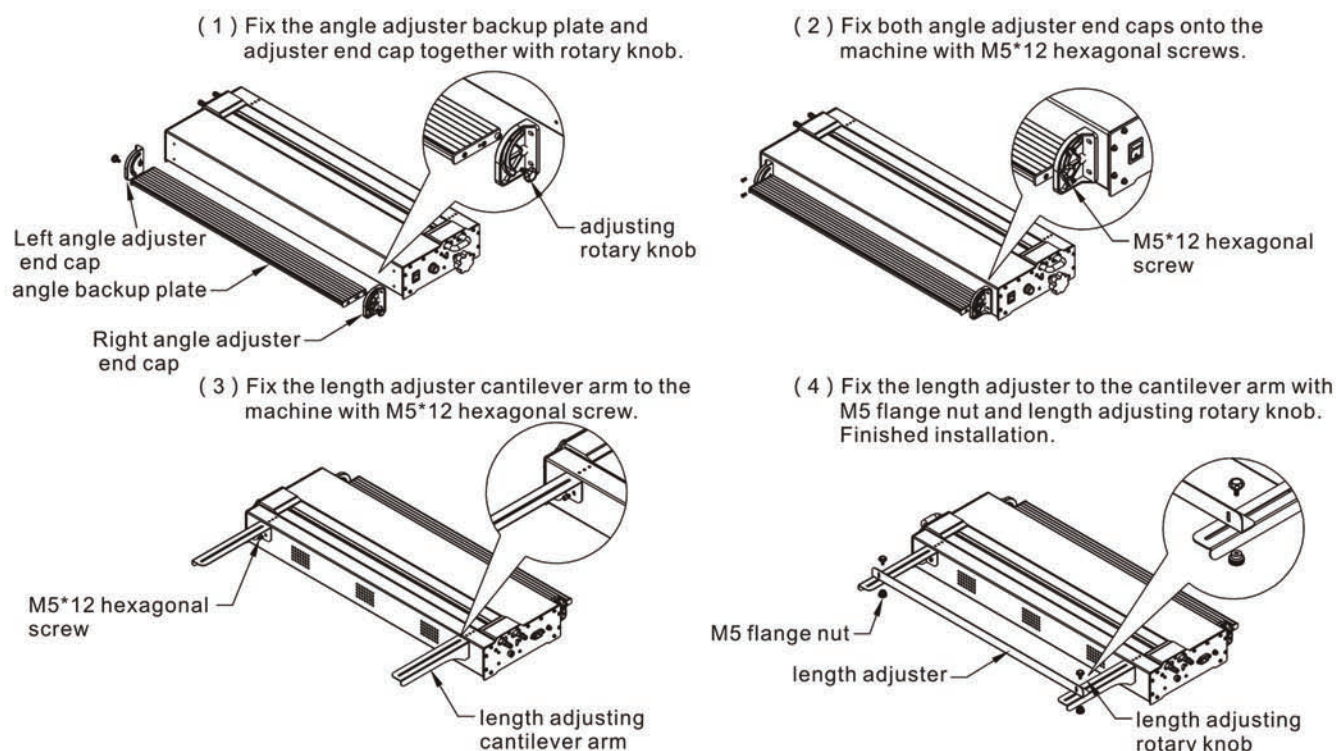

4. Function and instruction

4.1 Function declaration

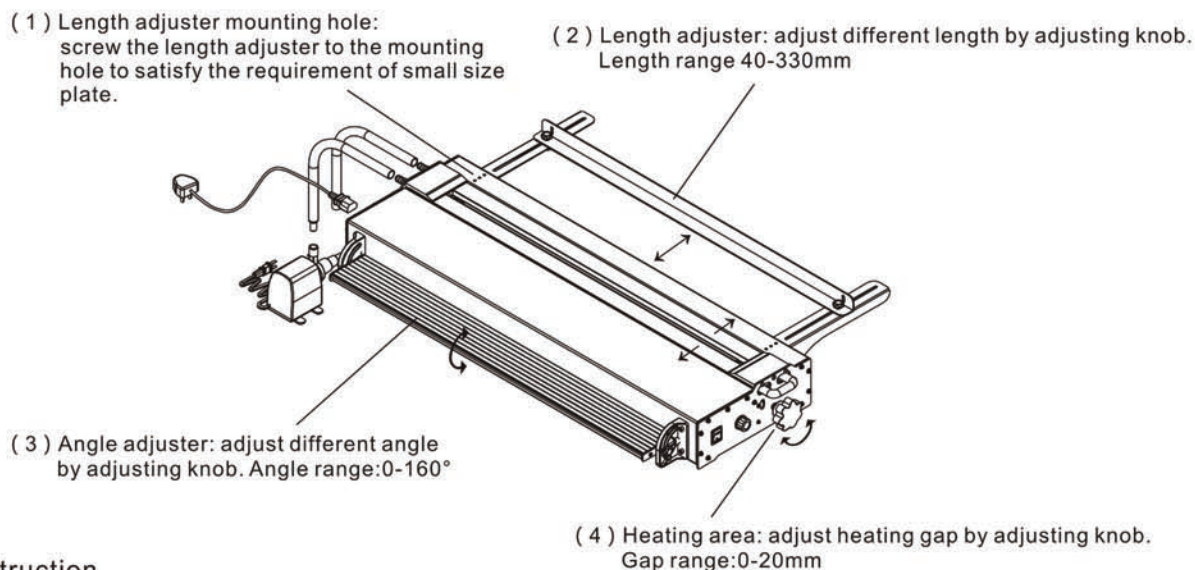

4.2 Instruction

- (1) 20L volume bucket or water tank, fill up with water, fix the submerged pump to the bottom of bucket/ tank.
- (2) Insert the plugs of submerged pump and main machine, turn on heating switch. The heating tube starts heating, cooling water starts to circulate.
- (3) Adjust the proper temperature according to the plate material and thickness, also adjust the heating surface controller gap to appropriate size.
- (4) Wait until the heating tube get red, put the material onto the work plate, make sure the material just above the heating tube.
- (5) Use length adjuster to confirm the heating position, if mass production.
- (6) Bend the soft material promptly with the help of angle adjuster, cool for a while.
- (7) Finish, turn off the heating switch, then the pump.

Special Version:

- (1) To protect machine and water pump, please change the water after circulating cooling system under heavy and long time working, temperature up to 50℃.
- (2) Ensure the machine cool completely first, turn off the heating tube gap after finished working.

5. FAQ

Problem 1: No heating

Fault: Check whether the power works or not.

Solution: Make sure the power on.

Fault: Whether the temperature controller is in lowest or not.

Solution: Adjust the temperature controller to a high scale.

Fault: Whether the fuse is intact or not.

Solution: Replace the fuse.

Problem 2: Can not pump the water

Fault: Whether the pump has electric to work or not.

Solution: Replace the damaged pump.

Fault: Whether there is much air in the tube.

Solution: Fill up two tubes with water, dip the pump into water.

- To ensure good understanding of the product for security, please be sure to read the manual and properly keep.
- Some contents and parameters of the product are subject to change without notice.
- The manual was compiled with great effort. But, we'd appreciated if you feedback any error or misprint.